

Sena SFR Quick Start Guide

ENGLISH

Ride Connected

Blast your favorite tunes, talk over the intercom with your buddies, hear directions from your GPS and more, all through your headset. With built-in Bluetooth® capabilities, Audio Overlay™, HD speakers and a microphone using Advanced Noise Control™, technology has never felt so minimal or freeing.

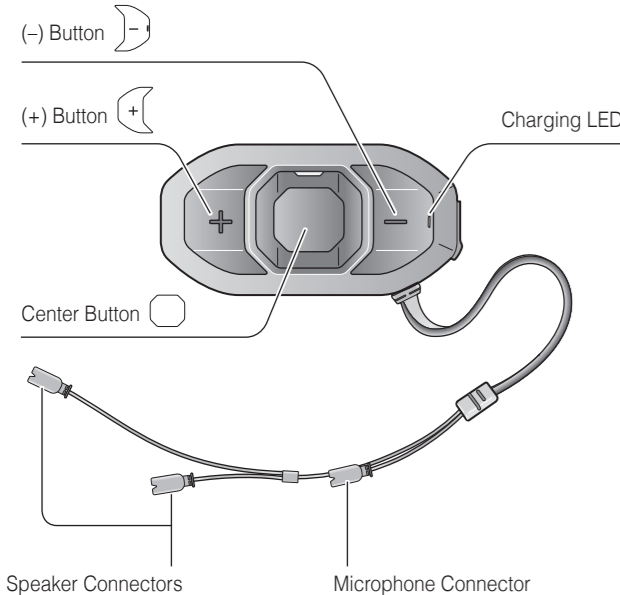

- BLUETOOTH 4.1**
- INTERCOM**
1.2 KM / 0.8 MILES
- FOUR-WAY INTERCOM**
- AUDIO OVERLAY**
- AUDIO SOURCE PRIORITY**
- ADVANCED NOISE CONTROL**
- FM SHARING**
- MUSIC SHARING**

Getting Started

1. This product comes with a Quick Start Guide, which is a basic version of the User's Guide. **A FULL VERSION OF THE USER'S GUIDE CAN BE DOWNLOADED AT SENA.COM/DOCUMENTS.**
2. Update this product for free with the latest firmware to fully enjoy the new advanced features built into this product. Visit sena.com/device-manager-download/ to see how to update your product.
3. Users can follow Sena on Facebook, YouTube, Twitter and Instagram to receive the most up to date information on products, helpful tips and all other announcements regarding Sena products.

SENA
Sena Technologies, Inc.
www.sena.com
 Customer Support: support.sena.com
 E-mail: support@sena.com

Installation

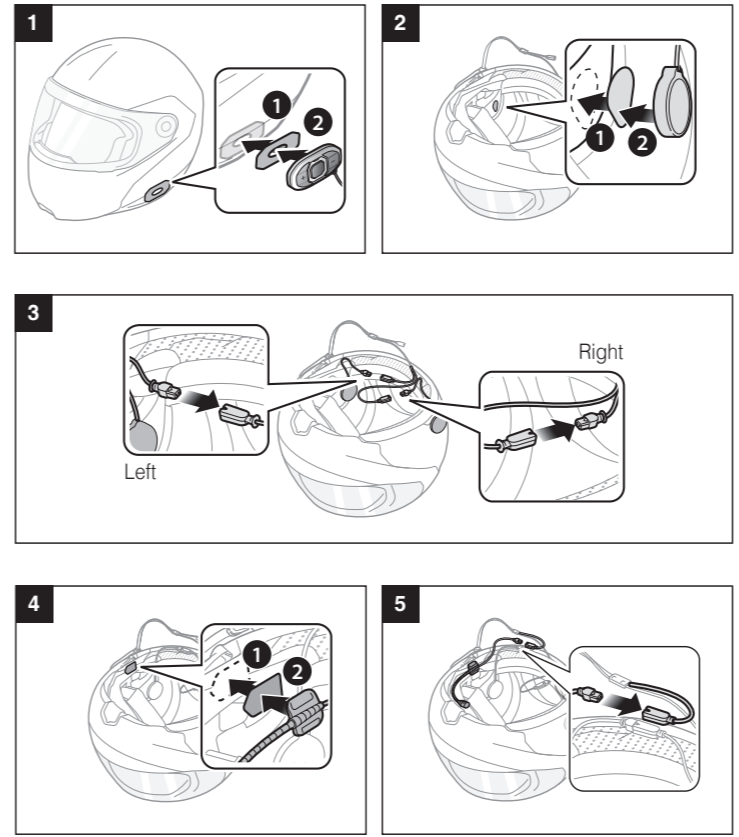

Charging

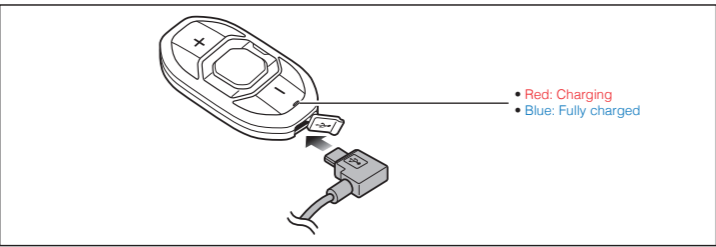

Button Operation

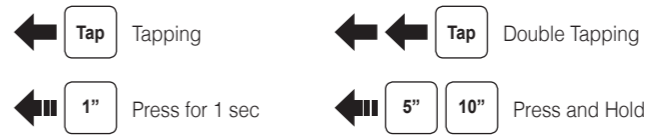

Power On/Off



Volume Adjustment

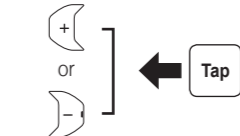

Battery Check

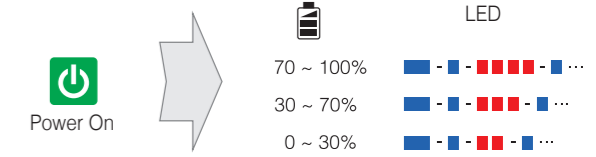

Phone, Music Pairing

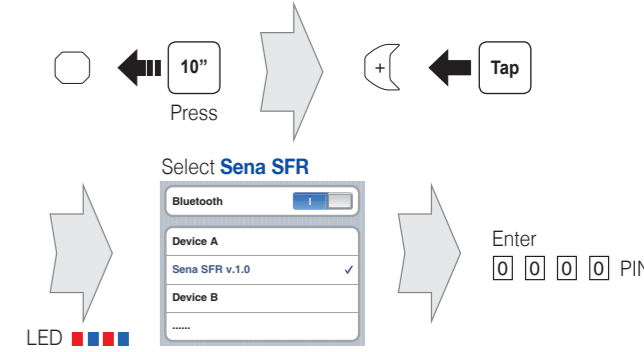

Music Operation

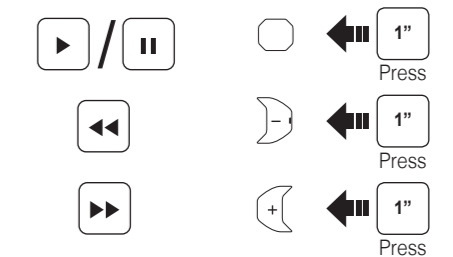

Mobile Phone Call Making and Answering

Answer Tap

End 2" Press

Voice Dial 3" Press

Speed Dial 3" Press

Reject 2" Press

Intercom Pairing

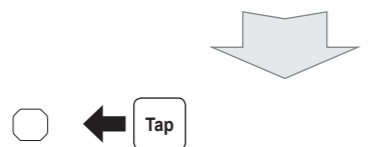
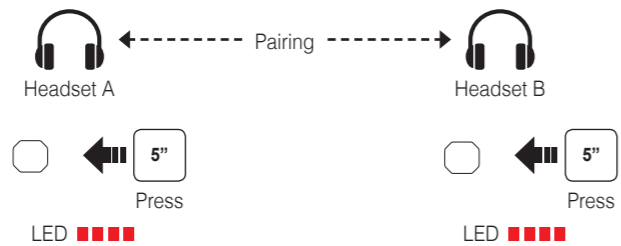

Intercom Start/End

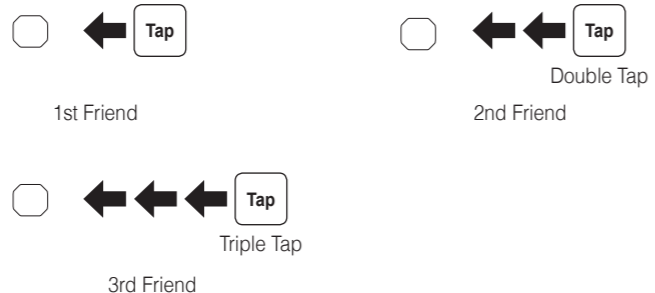

Radio On/Off



Radio Seek Stations

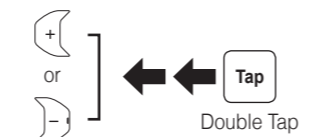

Radio Scan Up FM Band



Save to preset while scanning

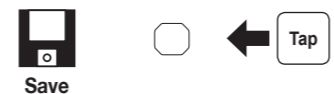

Setting

Configuration Menu



Using the Sena Device Manager

You can upgrade the headset's firmware and configure its settings directly from your PC or Apple computer. Download the Sena Device Manager, please visit sena.com.

Using the Sena SF Utility App

You can configure its settings directly from your smartphone. Download the Sena Smartphone App for Android or Apple operating systems from sena.com/SFseries-app.

Troubleshooting

Factory Reset

If you want to restore the SFR to factory default settings, use the Factory Reset in the configuration menu. The headset automatically restores the default settings and turns off.

Quick Reference

Type	Operation	Button Command
Basic Function	Power on	Press the Center Button and the (+) Button for 1 second
	Power off	Tap the Center Button and the (+) Button
	Volume up/down	Tap the (+) Button or the (-) Button
	Microphone Mute	Press the Center Button and the (-) Button for 1 second
Mobile Phone	Answer mobile phone call	Tap the Center Button
	End mobile phone call	Press the Center Button for 2 seconds
	Voice dial	Press the Center Button for 3 seconds
	Speed dial	Press the (+) Button for 3 seconds
	Reject incoming call	Press the Center Button for 2 seconds
Music	Play/Pause Bluetooth music	Press the Center Button for 1 second
	Track forward/back	Press the (+) Button or the (-) Button for 1 second

Quick Reference

Type	Operation	Button Command
Intercom	Intercom pairing	Press the Center Button for 5 seconds
		Tap the Center Button of any one of the two headsets
	Start/End each intercom	Tap the Center Button
	End all intercoms	Press the Center Button for 3 seconds
	Start Group Intercom	Tap the (+) Button and the (-) Button at the same time
FM Radio	End Group Intercom	Press the Center Button for 3 seconds
	FM radio on/off	Press the (-) Button for 1 second
	Select preset	Press the Center Button for 1 second
	Seek stations	Double tap the (+) Button or the (-) Button
	Scan up FM band/stop scanning	Press the (+) Button for 1 second
	Save preset while scanning	Tap the Center Button